

## Kompakt Otomatik Bağlantı Elemanları / Compact One-Touch Fittings

## Teknik Özellikler / Technical Specification

Akışkan / Fluid	Hava ( Diğer gazlar ve sıvılarda kullanılmaz ) / Air ( No other gases or liquids )
Çalışma Basıncı / Operating Pressure	0 ~ 9 bar / 0 ~ 0.9 MPa / 0 ~ 150 Psi
Negatif Basıncı ( Vakum ) / Negative Pressure	- 750 mm Hg / - 99.97 kPa
Sıcaklık / Temperature (C°)	0 ~ 60
Kullanılacak Hortum / Applicable Tube	Poliüretan ve Nylon / Polyurathane and Nylon

## Özellikler / Specification

- Benzer tiplerle mukayese edildiğinde hacimsel olarak %40 dış çap olarak %20 daha küçük olan dünyanın en küçük bağlantı elemanlarıdır. / The world's smallest quick-fitting joints feature 40% smaller volume ratio and 20% smaller O.D. ratio in comparison to the conventional type.
- Nikel kaplı bağlantı elemanları sadece görüntü olarak değil pasaya karşı mükemmel dayanım sağlar. / The compact type joints, which are nickel plated, excellent not only in appearance but also in rust resistance.
- Eliptik mandal, dar alanlarda hortumla bağlantı ve hortumdan sökmek için kolaylık sağlar. / The elliptical sleeve helps easy application or removal of the tube in confined spaces.

## Yapısal Diyagram / Structural Diagram

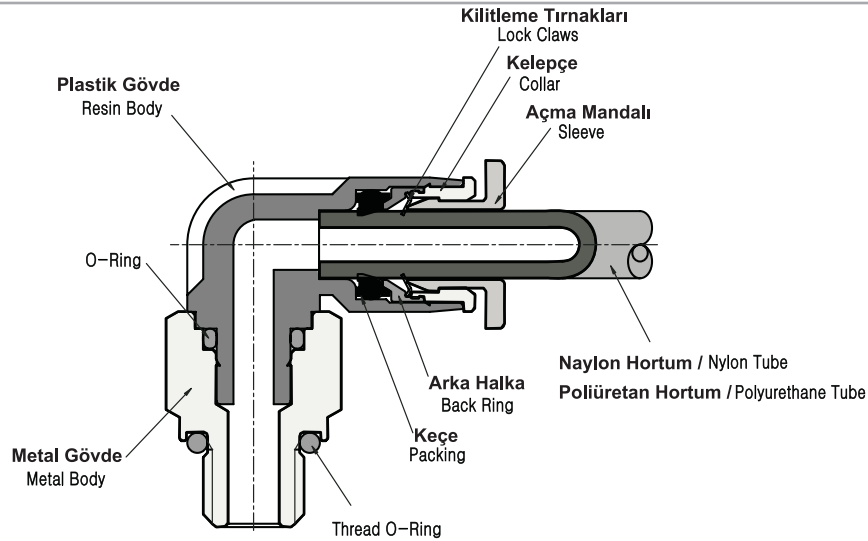

## Sipariş Kodu / Ordering Code

PC	06	01
Tip / Type	Hortum Çapı ( ØD ) / Tube Dia	Diş Ölçüsü ( T ) / Thread Size
Kompakt Otomatik Bağlantı Elemanları Compact One Touch Fittings	03: Ø3 04: Ø4 06: Ø6	M3: M3 x 0.5 M5: M5 x 0.8 M6: M6 x 1.0 01: R1/8

PC-C - Mini Erkek Rekor / Male Straight



Teknik Çizim / Technical Drawing

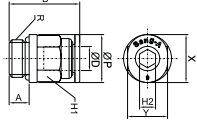

Ölçü Tablosu / Dimension Chart

MODEL	ØD	R	C	B	H	A	X	Y	Orifis (mm) Orifice (mm)	Ağırlık (g) Weight (g)	Adet/Kutu Qty / Box
PC 03-M3C	3	M3	9.5	13.6	6	3	7	6	1.2	1.3	100
PC 03-M5C		M5	9.5	15.7	8	3.5	7	6	2	3.1	100
PC 03-M6C		M6	9.5	16.5	8	4.5	7	6	2	3.3	100
PC 04-M3C	4	M3	11.5	17.2	8	3	10	8	1.2	3.2	100
PC 04-M5C		M5	11.5	15.7	8	3.5	10	8	2	2.9	100
PC 04-M6C		M6	11.5	16.9	8	4.5	10	8	3	3.2	100
PC 04-01C	6	G1/8	11.5	15.7	10	8	10	8	3	6	100
PC 06-M5C		M5	12.5	16.8	10	3.5	12	10	2	3.8	100
PC 06-M6C		M6	12.5	17.8	10	4.5	12	10	3	4.1	100
PC 06-01C	6	G1/8	12.5	17.9	10	8	12	10	4.5	5.3	100

PL-C - Döner Dirsek / Male Elbow



Teknik Çizim / Technical Drawing

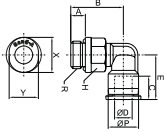

Ölçü Tablosu / Dimension Chart

MODEL	ØD	R	ØP	B	E	C	A	H	X	Y	Orifis (mm) Orifice (mm)	Ağırlık (g) Weight (g)	Adet/Kutu Qty / Box
PL 03-M3C	3	M3	6	12.4	11.2	9.5	3	6	7	6	1.2	1.6	100
PL 03-M5C		M5	6	13.5	11.2	9.5	3.5	8	7	6	2	2.7	100
PL 03-M6C		M6	6	14.5	11.2	9.5	4.5	8	7	6	2.4	3	100
PL 04-M3C	4	M3	8	14	15.6	11.5	3	8	10	8	1.2	3.3	100
PL 04-M5C		M5	8	13.5	15.6	11.5	3.5	8	10	8	2	3.3	100
PL 04-M6C		M6	8	14.5	15.6	11.5	4.5	10	10	8	2.4	3.7	100
PL 04-01C	6	G1/8	8	15.6	15.6	11.5	8	12	10	8	2.8	6.1	100
PL 06-M5C		M5	10.5	13.5	16.9	12.5	3.5	8	12	10	2	3.9	100
PL 06-M6C		M6	10.5	14.5	16.9	12.5	4.5	8	12	10	2.4	4.2	100
PL 06-01C	6	G1/8	10.5	16.9	16.9	12.5	8	10	12	10	3	6.8	100

PT-C - Orta Bacak Te / Tee



Teknik Çizim / Technical Drawing

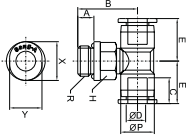

Ölçü Tablosu / Dimension Chart

MODEL	ØD	R	ØP	C	A	B	E	H	X	Y	Orifis (mm) Orifice (mm)	Ağırlık (g) Weight (g)	Adet/Kutu Qty / Box
PT 03-M3C	3	M3	6	9.5	3	12.4	11.2	6	7	6	1.2	2	100
PT 03-M5C		M5	6	9.5	3.5	13.5	11.2	8	7	6	2	3.2	100
PT 03-M6C		M6	6	9.5	4.5	14.5	11.2	8	7	6	2.4	3.5	100
PT 04-M3C	4	M3	8	11.5	3	15	13.1	8	10	8	1.2	4.2	100
PT 04-M5C		M5	8	11.5	3.5	14.5	13.1	8	10	8	2	4.1	100
PT 04-M6C		M6	8	11.5	4.5	15.5	13.1	10	10	8	2.4	4.4	100
PT 04-01C	6	G1/8	8	11.5	8	16.4	13.1	12	10	8	2.8	6.9	100
PT 06-M5C		M5	10.5	12.5	3.5	15.5	14.4	8	12	10	2	5.4	100
PT 06-M6C		M6	10.5	12.5	4.5	16.5	14.4	8	12	10	2.4	5.7	100
PT 06-01C	6	G1/8	10.5	12.5	8	17.4	14.4	10	12	10	3	8.2	100

POC-C - Mini Yuvarlak Rekor Bağlantı / Round Male Straight



Teknik Çizim / Technical Drawing

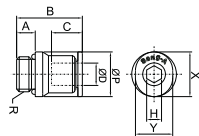

Ölçü Tablosu / Dimension Chart

MODEL	ØD	R	C	A	B	H	ØP	X	Y	Orifis (mm) Orifice (mm)	Ağırlık (g) Weight (g)	Adet/Kutu Qty / Box
POC 03-M3C	3	M3	9.5	3	15.9	1.5	6	7	6	1.2	1.7	100
POC 03-M5C		M5	9.5	3.5	17.5	2	8	7	6	2	3.8	100
POC 03-M6C		M6	9.5	4.5	19.7	3	8	7	6	2	4.2	100
POC 04-M3C	4	M3	11.5	3	18	1.5	8	10	8	1.2	3.4	100
POC 04-M5C		M5	11.5	3.5	18.7	2.5	8	10	8	2	3.8	100
POC 04-M6C		M6	11.5	4.5	19.7	3	8	10	8	3	4	100
POC 04-01C	6	G1/8	11.5	8	15.8	3	10	10	8	3	5.5	100
POC 06-M5C		M5	12.5	3.5	17.3	2.5	10	12	10	2	3.9	100
POC 06-M6C		M6	12.5	4.5	18.3	3	10	12	10	3	4.1	100
POC 06-01C	6	G1/8	12.5	8	16.9	4	10	12	10	4.5	4.5	100

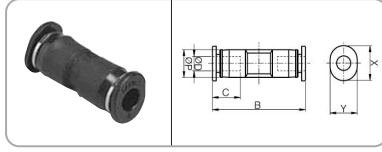
**PUC-C - Nipel Bağlantı / Union Straight**
**Teknik Çizim / Technical Drawing**

**Ölçü Tablosu / Dimension Chart**

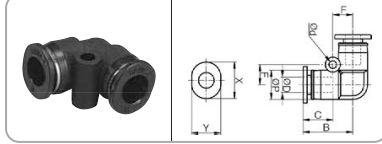
MODEL	ØD	ØP	B	C	X	Y	Orfis (mm) Orifice (mm)	Ağırlık (g) Weight (g)	Adet/Kutu Qty / Box
PUC 03C	3	6	20.4	9.5	7	6	2.5	1.1	100
PUC 04C	4	8	23.8	11.5	10	8	3	2	100
PUC 06C	6	10.5	25.1	12.5	12	10	4	3.2	100

**PUL-C - Dirsek / Union Elbow**
**Teknik Çizim / Technical Drawing**

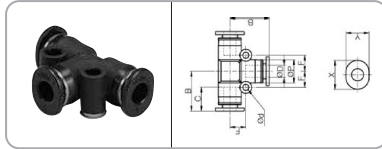
**Ölçü Tablosu / Dimension Chart**

MODEL	ØD	ØP	Ød	C	F	B	X	Y	Orfis (mm) Orifice (mm)	Ağırlık (g) Weight (g)	Adet/Kutu Qty / Box
PUL 03C	3	6	3.2	9.5	4.5	11.4	7	6	2.5	1.1	100
PUL 04C	4	8	3.2	11.5	5.8	13.9	10	8	3	2.1	100
PUL 06C	6	10.5	3.2	12.5	6.5	15.4	12	10	4	3.4	100

**PUT-C- T Bağlantı / Union Tee**
**Teknik Çizim / Technical Drawing**

**Ölçü Tablosu / Dimension Chart**

MODEL	ØD	ØP	Ød	F	C	B	X	Y	Orfis (mm) Orifice (mm)	Ağırlık (g) Weight (g)	Adet/Kutu Qty / Box
PUT 03C	3	6	3.2	4.5	9.5	11.4	7	6	2.5	1.7	100
PUT 04C	4	8	3.2	5.8	11.5	13.9	10	8	3	3.1	100
PUT 06C	6	10.5	3.2	6.5	12.5	15.4	12	10	4	5	100

**PST-C - Yan Bacak Te / Male Run Tee**

**Ölçü Tablosu / Dimension Chart**

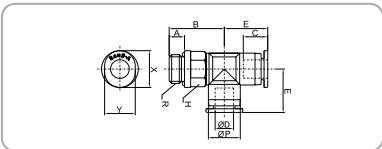
MODEL	ØD	R	ØP	C	A	B	E	H	X	Y	Orfis (mm) Orifice (mm)	Ağırlık (g) Weight (g)	Adet/Kutu Qty / Box
PST 03-M3C	3	M3	6	9.5	3	11.4	11.2	6	7	6	1.2	2	100
PST 03-M5C		M5	6	9.5	3.5	13.5	11.2	8	7	6	2	3.3	100
PST 03-M6C		M6	6	9.5	4.5	14.5	11.2	8	7	6	2.4	3.6	100
PST 04-M3C	4	M3	8	11.5	3	15	13.1	8	10	8	1.2	4.2	100
PST 04-M5C		M5	8	11.5	3.5	14.5	13.1	8	10	8	2	4.3	100
PST 04-M6C		M6	8	11.5	4.5	15.5	13.1	8	10	8	2.4	4.5	100
PST 04-01C	6	G1/8	8	11.5	8	16.4	13.1	10	10	8	2.8	7	100
PST 06-M5C		M5	10.5	12.5	3.5	16.5	14.4	8	12	10	2	5.6	100
PST 06-M6C		M6	10.5	12.5	4.5	17.5	14.4	8	12	10	2.4	5.9	100
PST 06-01C	6	G1/8	10.5	12.5	8	18	14.4	10	12	10	3	8.4	100

**Teknik Çizim / Technical Drawing**

**PLL-C - Uzun Dirsek / Extended Male Elbow**

**Ölçü Tablosu / Dimension Chart**

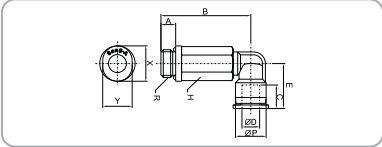
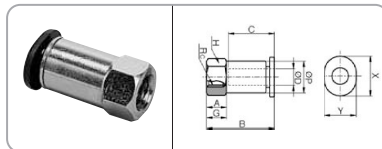
MODEL	ØD	R	ØP	B	E	C	A	H	X	Y	Orfis (mm) Orifice (mm)	Ağırlık (g) Weight (g)	Adet/Kutu Qty / Box
PLL 03-M3C	3	M3	6	19.4	11.2	9.5	3	6	7	6	1.2	3.1	100
PLL 03-M5C		M5	6	25.5	11.2	9.5	3.5	8	7	6	2	7.6	100
PLL 04-M3C	4	M3	8	23	15.6	11.5	3	8	10	8	1.2	7.4	100
PLL 04-M5C		M5	8	25.5	15.6	11.5	3.5	8	10	8	2	7.9	100
PLL 04-M6C		M6	8	26	15.6	11.5	4.5	8	10	8	2.4	8.3	100
PLL 04-01C	6	G1/8	8	28.1	15.6	11.5	8	10	10	8	2.8	13.2	100
PLL 06-M5C		M5	10.5	25.5	16.9	12.5	3.5	8	12	10	2	8.5	100
PLL 06-M6C		M6	10.5	26	16.9	12.5	4.5	8	12	10	2.4	8.9	100
PLL 06-01C	6	G1/8	10.5	29.4	16.9	12.5	8	10	12	10	3	13.7	100

**Teknik Çizim / Technical Drawing**

**PCF-C - Dişi Rekor/ Female Straight**
**Teknik Çizim / Technical Drawing**

**Ölçü Tablosu / Dimension Chart**

MODEL	ØD	Rc	G	C	A	B	H	ØP	X	Y	Orfis (mm) Orifice (mm)	Ağırlık (g) Weight (g)	Adet/Kutu Qty / Box
PCF 03-M3C	3	M3	5	9.5	3	14.9	8	8	7	6	2	3.8	100
PCF 03-M5C		M5	5	9.5	5	16.9	8	8	7	6	2.5	4.1	100
PCF 04-M3C	4	M3	5	11.5	3	15	8	8	10	8	2	3.7	100
PCF 04-M5C		M5	5	11.5	5	17	8	8	10	8	2.5	3.8	100

## PGJ-C - Boru Girişli Düşürücü / Reducer



## Ölçü Tablosu / Dimension Chart

MODEL	ØD1	ØD2	ØP	C1	C2	E	B	X	Y	Orfis (mm) Orifice (mm)	Ağırlık (g) Weight (g)	Adet/Kutu Qty / Box
PGJ 04-03C	3	4	6.5	9.5	11.5	11.2	29.2	7	6	2.5	0.9	100
PGJ 06-04C	4	6	9	11.5	12.5	13.2	33.2	10	8	3	1.8	100

## PW-C - Düşürücü Y / Reducer Y

## Teknik Çizim / Technical Drawing

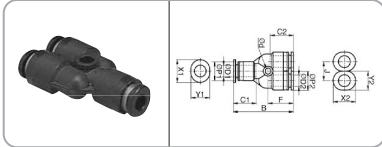

## Ölçü Tablosu / Dimension Chart

MODEL	ØD1	ØD2	ØP1	ØP2	Ød	F	J	C1	C2	B	X1	Y1	X2	Y2	Orfis (mm) Orifice (mm)	Ağırlık (g) Weight (g)	Adet/Kutu Qty / Box
PW 04-03C	4	3	8	8	3.2	13.4	8	11.5	9.5	30	10	8	7	6	2.5	3.6	100
PW 06-04C	6	4	10.5	8	3.2	13.6	10.5	12.5	11.5	31.5	12	10	10	8	3	4.1	100

## PWJ-C - Boru Girişli Düşürücü Y / Plug-In Reducer Y

## Teknik Çizim / Technical Drawing

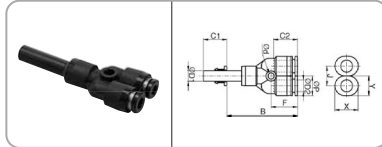

## Ölçü Tablosu / Dimension Chart

MODEL	ØD1	ØD2	ØP	C1	C2	Ød	F	J	B	X	Y	Orfis (mm) Orifice (mm)	Ağırlık (g) Weight (g)	Adet/Kutu Qty / Box
PWJ 04-03C	4	3	8	11.5	9.5	3.2	13.4	8	33	7	6	2	3.7	100
PWJ 06-04C	6	4	10.5	12.5	11.5	3.2	13.6	10.5	38.5	10	8	3	4.2	100

## PLJ-C - Boru Girişli Dirsek / Plug-In Elbow

## Teknik Çizim / Technical Drawing

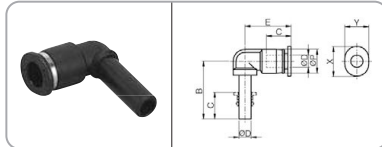

## Ölçü Tablosu / Dimension Chart

MODEL	ØD	ØP	C	B	E	X	Y	Orfis (mm) Orifice (mm)	Ağırlık (g) Weight (g)	Adet/Kutu Qty / Box
PLJ 03C	3	6	9.5	21.6	11.2	7	6	1.5	1.2	100
PLJ 04C	4	8	11.5	27.6	15.6	10	8	2	2	100
PLJ 06C	6	10.5	12.5	29.6	16.9	12	10	2.4	2.6	100

## PMM-C - Perde Geçiş Bağlantı / Bulkhead Union

## Teknik Çizim / Technical Drawing

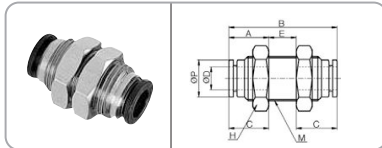

## Ölçü Tablosu / Dimension Chart

MODEL	ØD	M	ØP	A	E	B	H	C	Orfis (mm) Orifice (mm)	Ağırlık (g) Weight (g)	Adet/Kutu Qty / Box
PMM 03C	3	M8 X 0.75P	6	7	7.5	20	10	9.5	2	5.2	100
PMM 04C	4	M10 X 1.0P	8	9	7.5	24	12	11.5	3	8.6	100
PMM 06C	6	M12 X 1.0P	10.5	10.5	6	25.9	14	12.5	4	13.4	100

## PCC-C - Yuvarlak Rekor / Round Male Straight

## Teknik Çizim / Technical Drawing

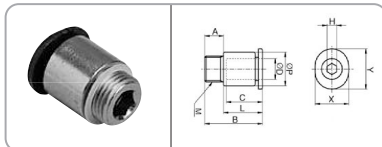

## Ölçü Tablosu / Dimension Chart

MODEL	ØD	M	L	C	A	B	H	ØP	X	Y	Orfis (mm) Orifice (mm)	Ağırlık (g) Weight (g)	Adet/Kutu Qty / Box
PCC 03-M6C	3	M6 X 0.75	11.1	9.5	3.5	14.6	2	8	7	6	2.5	2.9	100
PCC 04-M6C	4	M6 X 0.75	11	11.5	3.5	14.5	2.5	8	10	8	2.6	2.3	100
PCC 04-M8C	4	M8 X 0.75	10.5	11.5	4	14.5	3	10	10	8	3	4.6	100
PCC 06-M8C	6	M8 X 0.75	11.5	12.5	4	14.5	4	10	12	10	4	3.5	100

## PPF-C - Mini Körtapa / Cap

## Teknik Çizim / Technical Drawing

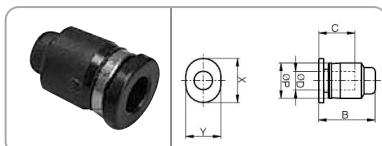

## Ölçü Tablosu / Dimension Chart

MODEL	ØD	ØP	B	C	X	Y	Ağırlık (g) Weight (g)	Adet/Kutu Qty / Box
PPF 03C	3	6	10.7	9.5	7	6	0.5	100
PPF 04C	4	8	12	11.5	10	8	1	100
PPF 06C	6	10.5	12.5	12.5	12	10	1.5	100

## PZA-C - Kruva / Union Cross

## Teknik Çizim / Technical Drawing

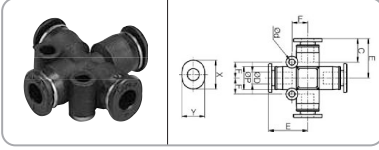

## Ölçü Tablosu / Dimension Chart

MODEL	ØD	ØP	Ød	F	E	C	X	Y	Orfis (mm) Orifice (mm)	Ağırlık (g) Weight (g)	Adet/Kutu Qty / Box
PZA 03C	3	6	3.2	4.5	11.5	9.5	7	6	2.5	2.2	100
PZA 04C	4	8	3.2	5.5	13.6	11.5	10	8	3	4.1	100
PZA 06C	6	10.4	3.2	6.5	15.9	12.5	12	10	4	6.6	100

## PYJ-C - Boru Girişli Y / Plug-In Y

## Teknik Çizim / Technical Drawing

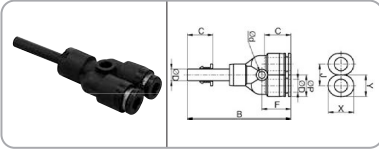

## Ölçü Tablosu / Dimension Chart

MODEL	ØD	ØP	Ød	F	C	J	B	X	Y	Orfis (mm) Orifice (mm)	Ağırlık (g) Weight (g)	Adet/Kutu Qty / Box
PYJ 03C	3	8	3.2	13.2	9.5	8	43.5	7	6	1.5	3	100
PYJ 04C	4	8	3.2	13.3	11.5	8	45	10	8	2	3.5	100
PYJ 06C	6	10.5	3.2	13.6	12.5	10.4	50.5	12	10	2.4	5.5	100

## PG-C - Redüksiyon Tipi Nipel / Reducer

## Teknik Çizim / Technical Drawing

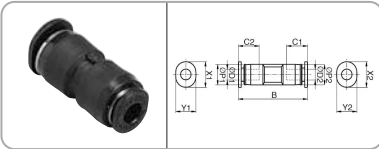

## Ölçü Tablosu / Dimension Chart

MODEL	ØD1	ØD2	ØP1	ØP2	C1	C2	B	X1	Y1	X2	Y2	Orfis (mm) Orifice (mm)	Ağırlık (g) Weight (g)	Adet/Kutu Qty / Box
PG 0403C	3	4	6	8	9.5	11.5	22.5	7	6	10	8	2.5	1.5	100
PG 0604C	4	6	8	10.5	11.5	12.5	24	10	8	12	10	3	2.5	100

## PY-C - Y Bağlantı / Union Y

## Teknik Çizim / Technical Drawing

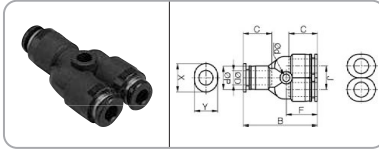

## Ölçü Tablosu / Dimension Chart

MODEL	ØD	ØP	Ød	F	C	J	B	X	Y	Orfis (mm) Orifice (mm)	Ağırlık (g) Weight (g)	Adet/Kutu Qty / Box
PY 03C	3	8	3.2	13.2	9.5	8	29.9	7	6	2.5	3.6	100
PY 04C	4	8	3.2	13.3	11.5	8	30.1	10	8	3	3.4	100
PY 06C	6	10.5	3.2	13.6	12.5	10.5	32.1	12	10	4	5.3	100

## PP-C - Körtapa / Plug

## Teknik Çizim / Technical Drawing

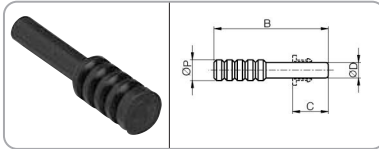

## Ölçü Tablosu / Dimension Chart

MODEL	ØD	B	C	ØP	Ağırlık (g) Weight (g)	Adet/Kutu Qty / Box
PP-C	3	22	9.5	4	0.3	100

## PLM-C - Perde Geçiş Dirseği / Bulkhead Union P

## Teknik Çizim / Technical Drawing

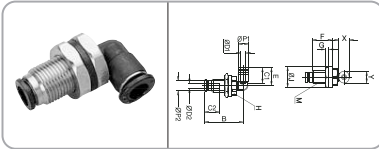

## Ölçü Tablosu / Dimension Chart

MODEL	ØP1	ØD1	ØP2	ØD2	E	C1	C2	B	F	G	H	ØJ	M	X	Y	Orfis (mm) Orifice (mm)	Ağırlık (g) Weight (g)	Adet/Kutu Qty / Box
PLM 03C	6.3	3	6	3	10.6	9.5	9.5	22.4	11	2	10	12.5	M8x0.75P	9	7	2.5	5.2	100
PLM 04C	8	4	8	4	15.3	11.5	11.5	24.4	13	3	12	14	M8x0.76P	10	8	3	8.6	100
PLM 06C	10.4	6	10	6	16.3	12.5	12.5	31.5	16.6	4	14	17	M8x0.77P	12	10	4	13.4	100

## NSE-C - Mini Dirsek Tipi Hız Ayar / Mini Elbow Speed Controller



## Teknik Çizim / Technical Drawing

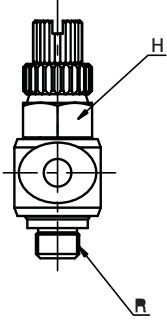

## Ölçü Tablosu / Dimension Chart

MODEL	ØD	R	C	F	A	H	ØP	ØK	L1(Max)	L2	Ağırlık (g) Weight (g)	Adet/Kutu Qty / Box
NSE 03-M3C	3	M3	9.5	14	4	8	6.3	10	26.5	6.9	6.7	100
NSE 03-M5C		M5	9.5	14	4	8	6.3	10	2.5	6.4	8.1	100
NSE 04-M3C	4	M3	11.5	15.7	4	8	8	10	26.5	6.9	17.5	100
NSE 04-M5C		M5	11.5	15.7	4	8	8	10	26.5	6.4	34.7	100
NSE 04-01C		G1/8	11.5	17.8	8	10	8	14	36	11.2	9.1	50
NSE 06-M3C	6	M3	12.5	16.4	4	8	10.4	10	26.5	6.9	18.2	100
NSE 06-M5C		M5	12.5	16.4	4	8	10.4	10	26.5	6.4	35.4	100
NSE 06-01C		G1/8	12.5	18.2	8	10	10.4	14	36	11.2	63.9	50
NSE 06-02C		G1/4	12.5	20.1	11	14	10.4	18	41.5	11.2	19.1	50

## NSF-C - Mini Hat Tipi Hız Ayar / Mini Union Straight Speed Controller

## Teknik Çizim / Technical Drawing

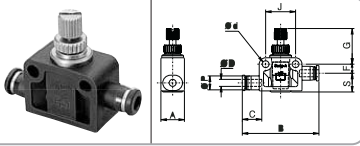

## Ölçü Tablosu / Dimension Chart

MODEL	ØD	A	B	Ød	C	F	G	J	ØP	S	Ağırlık (g) Weight (g)	Adet/Kutu Qty / Box
NSF 03C	3	11	33	3.2	9.5	4.25	13.5	14	6.3	8.75	8.75	50