

EI Kontrollü Valfler / Ball Valves

Teknik Özellikler / Technical Specification

Akışkan / Fluid	Hava (Diğer gazlar ve sıvılarda kullanılmaz) / Air (No other gases or liquids)
Çalışma Basıncı / Operating Pressure	0 ~ 9 bar / 0 ~ 0.9 MPa / 0 ~ 150 Psi
Negatif Basıncı (Vakum) / Negative Pressure	- 750 mm Hg / - 99.97 kPa
Sıcaklık / Temperature (C°)	0 ~ 60
Kullanılacak Hortum / Applicable Tube	Poliüretan ve Nylon / Polyurathane and Nylon

Kontrol Yöntemi / Control Method

- Hava kaynağını açık ya da kapalı konumunun kontrolünde kullanılır. / Used for controlling air supply in the opened and closed positions.
- PPS Reçineli gövdeyle hava gibi su için de kullanılabilir. / Available for water as well as air with PPS resin body.
- Gövdenin kesit ölçüleri hortumdaki kapasite kadar akışı sağlar. / The sectional dimension of the compact body optimizes as much flow as the tube capacity in proportion.

Yapısal Diyagram / Structural Diagram

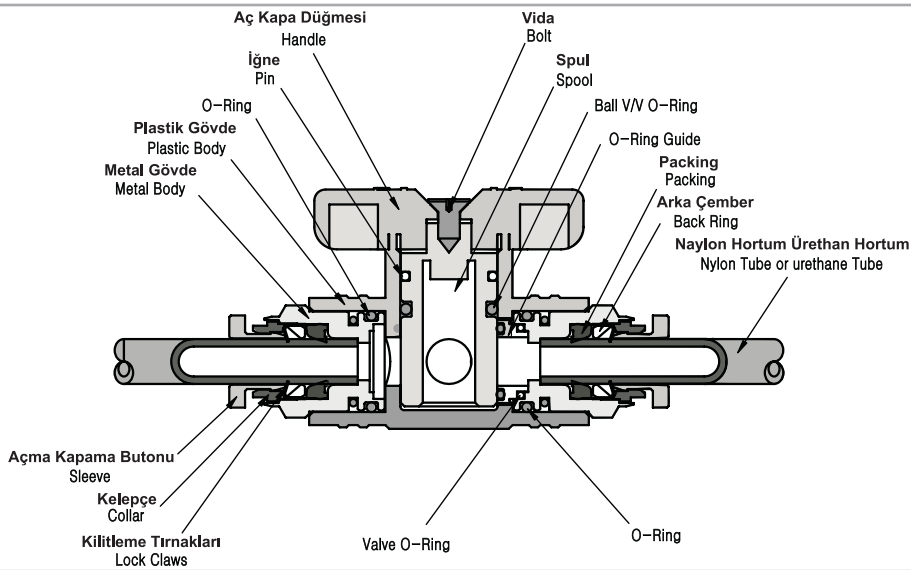

Sipariş Kodu / Ordering Code

BC	20	08	G02
Tip / Type	Efektif Kesit Alanı Effective Sectional Area	Hortum Çapı (ØD) / Tube Dia	Diş Ölçüsü (T) / Thread Size
EI Kontrollü Valfler Ball Valves	20: 20mm 60: 60mm	06: Ø6 08: Ø8 10: Ø10 12: Ø12	G01: 1/8" G02: 1/4" G03: 3/8" G04: 1/2"

BUC - El Kontrollü Vana / Union

Teknik Çizim / Technical Drawing

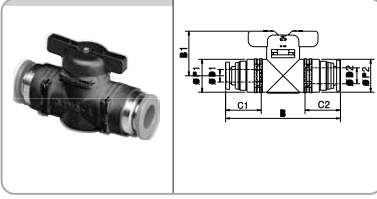

Ölçü Tablosu / Dimension Chart

MODEL	ØD1	ØD2	C1	C2	ØP1	ØP2	B	B1	Orfis (mm) Orifice (mm)	Ağırlık (g) Weight (g)	Adet/Kutu Qty / Box
BUC 20-0606	6	6	17	17	17	17	59.4	23	5	45	25
BUC 20-0808	8	8	18.5	18.5	17	17	59.2	23	6	40.5	25
BUC 60-1010	10	10	21	21	24	24	78.4	28	8	102.5	12
BUC 60-1212	12	12	22	22	24	24	79.3	28	9	98	12

BUG - Orantılı El Kontrollü Vana / Reducing Union

Teknik Çizim / Technical Drawing

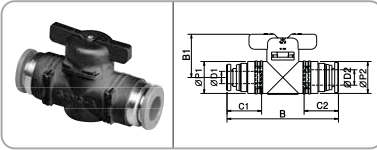

Ölçü Tablosu / Dimension Chart

MODEL	ØD1	ØD2	C1	C2	ØP1	ØP2	B	B1	Orfis (mm) Orifice (mm)	Ağırlık (g) Weight (g)	Adet/Kutu Qty / Box
BUG 20-0806	8	6	18.5	17	17	17	59.3	23	5	42.5	25
BUG 60-1210	12	10	22	21	24	24	77.8	28	8	100.5	12

BM - El Kontrollü Perde Geçiş Vana / Bulkhead Union



Ölçü Tablosu / Dimension Chart

MODEL	ØD1	ØD2	M	C1	C2	ØP	H1	H2	E	B	B1	Orfis (mm) Orifice (mm)	Ağırlık (g) Weight (g)	Adet/Kutu Qty / Box
BM 20-0606	6	6	M16	17	17	17	19	19	43.9	73.6	23	5	44	25
BM 20-0806	8	6	M16	18.5	17	17	19	19	44.4	74.1	23	5	48	25
BM 20-0808	8	8	M16	18.5	18.5	17	19	19	44.4	74.1	23	6	46	25
BM 60-1010	10	10	M22	21	21	24	24	26	55.6	94	28	8	110.1	12
BM 60-1210	12	10	M22	22	21	24	24	26	55.0	93.45	28	8	116	12
BM 60-1212	12	12	M22	22	22	24	24	26	55.0	95.45	28	9	114	12

Teknik Çizim / Technical Drawing

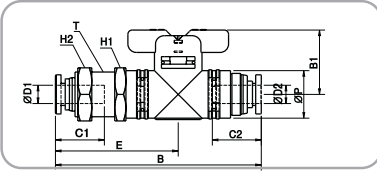

BL - Dirsek Tipi El Kontrollü Vana / Elbow



Ölçü Tablosu / Dimension Chart

MODEL	ØD	R	C	ØP	E	L	A	ØK	H	B	B1	Orfis (mm) Orifice (mm)	Ağırlık (g) Weight (g)	Adet/Kutu Qty / Box
BL 20-06G01	6	G1/8	17	17	23	30.75	6	17	17	53.75	29.75	5	56.5	25
BL 20-06G02		G1/4	17	17	23	32.25	8	17	17	55.25	29.75	5	59.5	25
BL 20-06G03		G3/8	17	17	23	34.75	10	17	21	57.75	29.75	5	68	25
BL 20-08G01	8	G1/8	18.5	17	23	30.75	6	17	17	53.75	30.25	6	54.0	25
BL 20-08G02		G1/4	18.5	17	23	32.25	8	17	17	55.75	30.25	6	57.5	25
BL 20-08G03		G3/8	18.5	17	23	34.75	10	17	21	57.75	30.25	6	66	25
BL 60-10G02	10	G1/4	21	24	28	42.1	8	24	24	70.1	40.1	8	133	12
BL 60-10G03		G3/8	21	24	28	44.1	10	24	24	72.1	40.1	8	135.5	12
BL 60-10G04		G1/2	21	24	28	46.1	12	24	24	74.1	40.1	8	152.5	12
BL 60-12G02	12	G1/4	22	24	28	42.1	8	24	24	70.1	40	8	131	12
BL 60-12G03		G3/8	22	24	28	44.1	10	24	24	72.1	40	9	133.5	12
BL 60-12G04		G1/2	22	24	28	46.1	12	24	24	74.1	40	9	150.5	12

Teknik Çizim / Technical Drawing

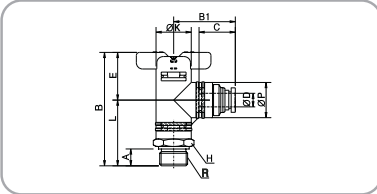

BUL - El Kontrollü Dirsek Vana / Union Elbow



Ölçü Tablosu / Dimension Chart

MODEL	ØD1	ØD2	C1	C2	ØP1	ØP2	ØK	B	L	B1	Orfis (mm) Orifice (mm)	Ağırlık (g) Weight (g)	Adet/Kutu Qty / Box
BUL 20-0606	6	6	17	17	17	17	17	52.75	29.75	29.75	5	46	25
BUL 20-0808	8	8	18.5	18.5	17	17	17	52.65	30.25	30.25	6	41.5	25
BUL 60-1010	10	10	21	21	24	24	24	39.3	39.3	39.3	8	105.5	12
BUL 60-1212	12	12	22	22	24	24	24	40.3	40.3	40.3	9	101	12

Teknik Çizim / Technical Drawing

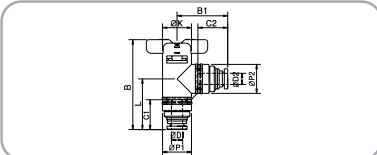

BC- El Kontrollü Vana / Straight



Teknik Çizim / Technical Drawing

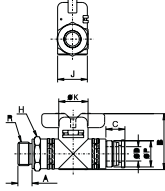

Ölçü Tablosu / Dimension Chart

MODEL	ØD	R	C	ØP	E	L	A	ØK	H	B	B1	Orfis (mm) Orifice (mm)	Ağırlık (g) Weight (g)	Adet/Kutu Qty / Box
BL 20-0601	6	G1/8	17	17	23	30.75	6	17	17	53.75	29.75	5	56.5	25
BL 20-0602		G1/4	17	17	23	32.25	8	17	17	55.25	29.75	5	59.5	25
BL 20-0603		G3/8	17	17	23	34.75	10	17	21	57.75	29.75	5	68	25
BL 20-0801	8	G1/8	18.5	17	23	30.75	6	17	17	53.75	30.25	6	54.0	25
BL 20-0802		G1/4	18.5	17	23	32.25	8	17	17	55.75	30.25	6	57.5	25
BL 20-0803		G3/8	18.5	17	23	34.75	10	17	21	57.75	30.25	6	66	25
BL 60-1002	10	G1/4	21	24	28	42.1	8	24	24	70.1	40.1	8	133	12
BL 60-1003		G3/8	21	24	28	44.1	10	24	24	72.1	40.1	8	135.5	12
BL 60-1004		G1/2	21	24	28	46.1	12	24	24	74.1	40.1	8	152.5	12
BL 60-1202	12	G1/4	22	24	28	42.1	8	24	24	70.1	40	8	131	12
BL 60-1203		G3/8	22	24	28	44.1	10	24	24	72.1	40	9	133.5	12
BL 60-1204		G1/2	22	24	28	46.1	12	24	24	74.1	40	9	150.5	12

BLM - El Kontrollü Perde Geçişli Dirsek Vana / Bulkhead Union Elbow



Teknik Çizim / Technical Drawing

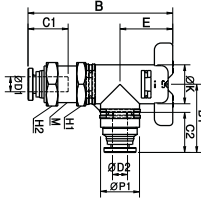

Ölçü Tablosu / Dimension Chart

MODEL	ØD1	ØD2	M	C1	C2	ØP1	E	ØK	B	H1	H2	B1	Orfis (mm) Orifice (mm)	Ağırlık (g) Weight (g)	Adet/Kutu Qty / Box
BLM 20-0606	6	6	M16	17	17	17	23	17	63.15	19	19	23	5	46	25
BLM 20-0806	8	6	M16	18.5	17	17	23	17	66.95	19	19	23	5	49	25
BLM 20-0808	8	8	M16	18.5	18.5	17	23	17	67.2	19	19	23	6	47	25
BLM 60-1010	10	10	M22	21	21	24	28	24	84.5	24	26	28	8	105	12
BLM 60-1210	12	10	M22	22	21	24	28	24	84.5	24	26	28	8	119	12
BLM 60-1212	12	12	M22	22	22	24	28	24	84	24	26	28	9	117	12

BLG - El Kontrollü Düşürücü Tip Dirsek Vana / Reducing Union Elbow



Teknik Çizim / Technical Drawing

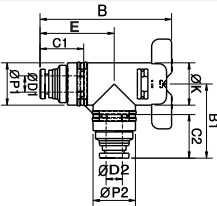

Ölçü Tablosu / Dimension Chart

MODEL	ØD1	ØD2	C1	C2	ØP1	ØP2	E	ØK	B	B1	Orfis (mm) Orifice (mm)	Ağırlık (g) Weight (g)	Adet/Kutu Qty / Box
BLG 20-0608	6	8	17	18.5	17	17	29.75	17	52.75	29.75	5	43.5	25
BLG 20-0806	8	6	18.5	17	17	17	30.25	17	53.25	30.25	5	43.5	25
BLG 60-1012	10	12	21	22	24	24	40.1	24	68.1	39.3	8	103.5	12
BLG 60-1210	12	10	22	21	24	24	40.3	24	68.3	40.3	8	103.5	12