

Solenoid Bobin Serisi / Solenoid Coil Series

Özellikler / Specification

Model / Model	SC1	SC2
Voltaj Toleransı / Voltage Tolerances	±10% da Voltaj Aralığı / ±10% of Rated Voltage	
Yalıtım / Insulation	F Sınıfı / F Class	
Sıcaklık / Temperature	5 ~ 60 °C / 41 ~ 140 °F	
Güç Tüketimi / Power Consumption	AC: 3.5VA (60Hz)	AC: 5.5VA (60Hz)
	AC: 4.5VA (50Hz)	AC: 6.5VA (50Hz)
	DC: 2.5W	DC: 2.5W

Sipariş Kodu / Ordering Code

SC1	A2
Solenoid Bobin Tipi / Solenoid Coil Type	Voltaj / Voltage
SC1: 15 mm - 3'lü Bağlantı / SC1: 15 mm - 3 Pin Connector Coil	0: Yok / 0: None
SG1: 15 mm - Kaçuk Rondelalı / SG1: 15 mm - Grommet / Flying Leads	A2: AC 220V
SD1: 15 mm - Kaçuk Rondelalı ve LED'li / SD1: 15 mm - Grommet / Flying Leads With LED	A1: AC 110V
SL1: 90 Derece Fişli Kablo LED'li / SL1: 90 Degree Plug-in Wire Assembly LED	A4: AC 24V
SM1: 180 Derece Fişli Kablo LED'li / SM1: 180 Degree Plug-in Wire Assembly LED	D4: DC 24V
SC2: 22 mm - 3'lü Bağlantı / SC2: 22 mm - 3 Pin Connector Coil	D2: DC 12V
SG2: 22 mm - Kaçuk Rondelalı / SG2: 22 mm - Grommet / Flying Leads	
SD2: 22 mm - Kaçuk Rondelalı ve LED'li / SD2: 22 mm - Grommet / Flying Leads With LED	

Parçaların Malzemeleri / Material of Parts

Parça / Item	Malzeme / Material
Gövde / Body	Cam Takviyeli Naylon / Glass Filled Nylon
Kablo / Lead Wire	AWG-NO.22, NO.24
Kablo Koruması / Lead Wire Packing	Viton / Viton
İç Boru / Yoke	Karbon Çeliği / Carbon Iron
Belirteç / Indicator	Polikarbonat / Polycarbonat

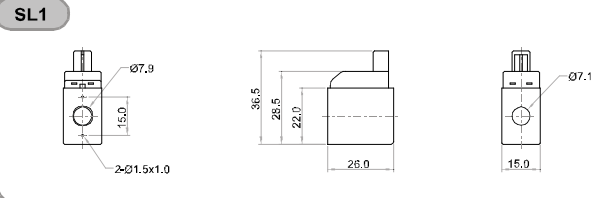
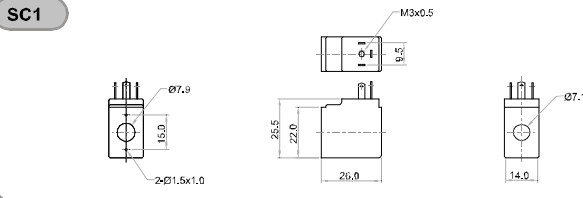
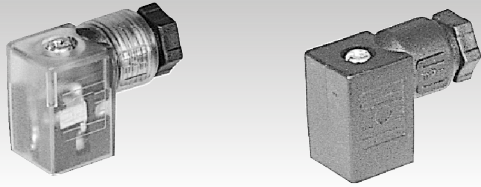
Teknik Çizimler / Technical Drawings

DIN Soket Serisi / DIN Connector Series

Özellikler / Specification

Model / Model	CN1	CN2
Voltaj Toleransı / Voltage Tolerances	±10% da Voltaj Aralığı / ±10% of Rated Voltage	
Koruma / Protection	IP65 (Bobin ile Birlikte / With Coil)	
Sıcaklık / Temperature	5 ~ 60 °C / 41 ~ 140 °F	
Max. Akım / Max Current	2.5 A	
İletkenlik Kesiti / Section Conductance	Max. 0.75 mm ²	Max. 1.50 mm ²

Sipariş Kodu / Ordering Code

SC1	A2
Solenoid Bobin Tipi / Solenoid Coil Type	Voltaj / Voltage
CN1: 15 mm - Normal Soket / CN1: 15 mm - Normal Connector	A2: AC 220V
CD1: 15 mm - Soket LED'li / CD1: 15 mm - Connector With LED	A1: AC 110V
CZ1: 15 mm - Soket LED'li ve Şok Emicili / CZ1: 15 mm - Connector With LED & Surge Suppressor	A4: AC 24V
CN2: 22 mm - Normal Soket / CN2: 22 mm - Normal Connector	D4: DC 24V
CD2: 22 mm - Soket LED'li / CD2: 22 mm - Connector With LED	D2: DC 12V
CZ2: 22 mm - Soket LED'li ve Şok Emicili / CZ2: 22 mm - Connector With LED & Surge Suppressor	
CNM2: 24 mm - Normal Soket / CNM2: 24 mm - Normal Connector	
CDM2: 24 mm - Soket LED'li / CDM2: 24 mm - Connector With LED	
CZM2: 24 mm - Soket LED'li ve Şok Emicili / CZM2: 24 mm - Connector With LED & Surge Suppressor	

Parçaların Malzemeleri / Material of Parts

Parça / Item	Malzeme / Material
Gövde / Body	Cam Takviyeli Naylon / Glass Filled Nylon
Kablo / Lead Wire	AWG-NO.22, NO.24
Kablo Koruması / Lead Wire Packing	Viton / Viton
İç Boru / Yoke	Karbon Çeliği / Carbon Iron
Belirteç / Indicator	Polikarbonat / Polycarbonat

Teknik Çizimler / Technical Drawings
